



**SUBMITTAL DATA**  
**FIXED DIAPHRAGM HYDRO-PNEUMATIC TANKS**  
**FXT SERIES, 125 PSI ASME CODE**  
**FOR WELL & BOOSTER SYSTEMS**

**Models and Dimensions**

Model Number	Tank Volume (gal.)	Accept. Volume (gal.)	Accept. Factor	Drawdown (gal)			Dimensions (IN.)		System Conn. (NPT)	Ship Weight (lbs.)
				Differential (psig)			Dia.	Height		
				20/40	30/50	40/60				
FXT 401	15	10.5	0.70	5.9	4.9	4.3	14	27	1"	64
FXT 402	25	10.5	0.42	9.2	7.7	6.7	14	42	1"	84
FXT 403	35	10.5	0.30	13	10.8	9.4	14	57	1"	97
FXT 404	70	52.8	0.75	26	22	19	24	46	1 1/2"	259
FXT 405	90	52.8	0.59	33	28	24	24	52	1 1/2"	283

**Materials of Construction**

Shell:	Steel
Diaphragm:	Heavy Duty Butyl**
System Connection:	Stainless Steel

\*\*FDA listed material

**Maximum Operating Conditions**

Working Temperature:	240° F
Working Pressure:	125 PSIG

**Designed, constructed, and stamped in accordance to ASME Code, Section VIII, Division 1.**

**Standard Factory Pre-charge = 30 PSIG**

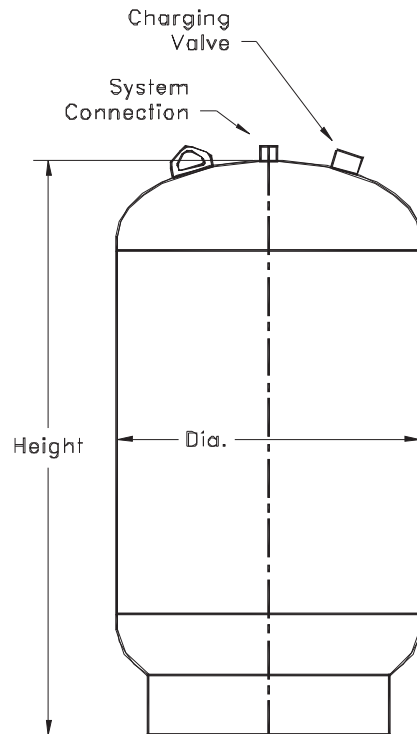

**FXT 401 through FXT 405**

Job Name \_\_\_\_\_  
 Location \_\_\_\_\_  
 \_\_\_\_\_  
 Engineer \_\_\_\_\_  
 Architect \_\_\_\_\_  
 Sales Rep. \_\_\_\_\_  
 Contractor \_\_\_\_\_

Model Number \_\_\_\_\_  
 Temperature \_\_\_\_\_  
 Capacity \_\_\_\_\_  
 Liquid \_\_\_\_\_  
 Notes \_\_\_\_\_  
 \_\_\_\_\_  
 \_\_\_\_\_